

SURVEY CONTROL DATA

1. HORIZONTAL DATUM IS THE OKLAHOMA STATE PLANE COORDINATE SYSTEM, N.A.D. 83(2011) LAMBERT PROJECTION, SOUTH ZONE ADJUSTED TO N.G.S. STATE PLANE COORDINATES, UTILIZING OPUS.
- A. ACCURACY - 3RD ORDER OR BETTER.
2. BEARINGS:
THE BEARINGS SHOWN HEREIN OR HEREON ARE GRID BEARINGS DERIVED FROM THE USC & GS OKLAHOMA PLANE COORDINATE SYSTEM AND ARE NOT ASTRONOMICAL.
3. VERTICAL CONTROLS:
A. LEVEL DATUM IS NGS, NAVD 88, TAKEN FROM ADJUSTED PRIMARY CONTROL UTILIZING DIFFERENTIAL LEVELING TECHNIQUES.
B. ACCURACY - 3RD ORDER OR BETTER.

BEGIN
LATITUDE 34° 01' 39"
LONGITUDE 97° 25' 19"
END
LATITUDE 34° 01' 39"
LONGITUDE 97° 19' 02"

DESIGN DATA

ADT 2011 - 200
ADT 2031 - 250
T3% - 15%
D% - 55%
V - 45 M.P.H.
FLEX ESAL'S - 0.32 M

SCALES

PLAN 1:50
PROFILE HOR. 1:50
VER. 1:5
LAYOUT MAP 1" = 5280'

CONVENTIONAL SIGNS

- PROPOSED ROADS
- SECTION LINES
- QUARTER SECTION LINES
- FENCES
- EXISTING GRADE
- EXISTING ROADS
- BASE LINE
- PROPOSED GRADE
- COMMUNICATION LINES (EXISTING)
- POWER LINES (EXISTING)
- GAS LINE (EXISTING)
- SANITARY SEWER LINES (EXISTING)
- WATER LINES (EXISTING)
- COMMUNICATION LINES (PROPOSED)
- POWER LINES (PROPOSED)
- GAS LINE (PROPOSED)
- SANITARY SEWER LINES (PROPOSED)
- WATER LINES (PROPOSED)
- BUILDINGS
- DRAINAGE STRUCTURES (EXISTING)
- DRAINAGE STRUCTURES (PROPOSED)
- RIGHT-OF-WAY LINES (EXISTING)
- RIGHT-OF-WAY LINES (PROPOSED)
- RIGHT-OF-WAY FENCE
- FLOWLINE (EXISTING)
- FLOWLINE (PROPOSED)
- TOE OF SLOPE (EXISTING)
- TOE OF SLOPE (PROPOSED)
- CITY LIMITS
- LANDSCAPE

STATE OF OKLAHOMA
DEPARTMENT OF TRANSPORTATION

PLAN OF PROPOSED
COUNTY ROAD
GRADE, DRAIN, SURFACE, AND BRIDGE
OSWALT ROAD
LOVE COUNTY

STATE AID PROJECT NO. CIRB-143C(091)RB
STATE JOB NO. 25447(04)

STRUCTURE NO. 43E2060N3150008, REMOVE NBI NO. 09615, CONSTRUCT NBI NO. 31914
STRUCTURE NO. 43E2060N3160009, CONSTRUCT NBI NO. 31915
STRUCTURE NO. 43E2060N3170003, EXTEND NBI NO. 07924

FED. ROAD DIST. NO.	PROJECT NO.	SHEET NO.	TOTAL SHEETS
6	CIRB-143C(091)RB	1	130

UPDATED INDEX OF SHEETS 8/24/17

INDEX OF SHEETS

SHEET NO.	DESCRIPTION	SHEET NO.	DESCRIPTION
001.	TITLE SHEET	B008.	DETAIL RCB1H-1
002.	TYPICAL SECTIONS AND GENERAL NOTES	B009.	DETAIL RCB1-1
AR01.	SUMMARY OF ROADWAY PAY QUANTITIES	B010.	DETAIL RCB3-1
AB01.	BRIDGE PAY ITEM AND NOTES	B011.	DETAIL BC-5A2
AX01-AX04.	SUMMARY TABLES	B012.	DETAIL BC-6S2 RF
R001.	STORMWATER MANAGEMENT PLAN	B013.	DETAIL BC-6S2 LF
R002-R012.	EROSION CONTROL PLAN	B014.	DETAIL BC-6AS2
R013.	DRAINAGE AREA MAP	B015.	BRIDGE "C" NORTH RCB BARREL DETAILS
R014-R019.	MASS HAUL DIAGRAMS	B016.	BRIDGE "C" SOUTH RCB BARREL DETAILS
R020-R030.	ALIGNMENT DATA SHEETS	B017.	BRIDGE "C" SOUTH RCB BARREL DETAILS
R031-R052.	PLAN AND PROFILE	B018.	BRIDGE "C" NORTH END SECTION DETAILS
B001.	BRIDGE "A" GENERAL PLAN AND ELEVATION	B019.	BRIDGE "C" NORTH END SECTION DETAILS
B002.	BRIDGE "B" GENERAL PLAN AND ELEVATION	B020.	BRIDGE "C" SOUTH END SECTION DETAILS
B003.	BRIDGE "C" GENERAL PLAN AND ELEVATION	B021.	BRIDGE "C" SOUTH END SECTION DETAILS
B004.	STRUCTURE 53 DETAIL SHEET	X001-X049.	X-SECTIONS
B005.	STRUCTURE 53 DETAIL SHEET		
B006.	STRUCTURE 53 DETAIL SHEET		
B007.	STRUCTURE 54 DETAIL SHEET		

THE FOLLOWING STANDARDS WILL BE REQUIRED FOR THIS PROJECT.

BRIDGE	ROADWAY	TRAFFIC	TRAFFIC
RCB-C3-10(2-12)-02E	SSS-1-1	GRAU1-1-00	PM3-1-02
RCB-E3-H5-0-1-01E	TSC2-3-2	GRH1-1-00	DJ2-1-00
RCB-CW3-D4-0-01E	TSD-2-0	GRH2-1-00	RSD1-1-00
CB26..32-C..1-SKO..30-GRAU-BC-00E	PSE-1-0	TCS1-1-01	RSD2-1-00
	PCES-4-1	TCS2-1-00	SBS1-1-00
	CDIB-1-0	TCS3-1-01	SBS2-1-00
	CDIP-1-1	TCS4-1-01	SBS3-1-00
	SSCD-3-1	TCS5-1-00	SBS4-1-00
	SPI-4-1	TCS6-1-02	GMS1-1-00
	SPB-1-4	TCS7-1-02	SSA1-1-00
	FHTMPP-1-0	TCS8-1-00	SSP1-1-02
	FHTCP-3-1	TCS9-1-01	
	SBI-4-2	TCS10-1-00	
	MI-3-0		
	RDI-3-1		
	DC-3-2		
	RWF2-2-1		
	ECM2-3-0		
	SMD-3-1		

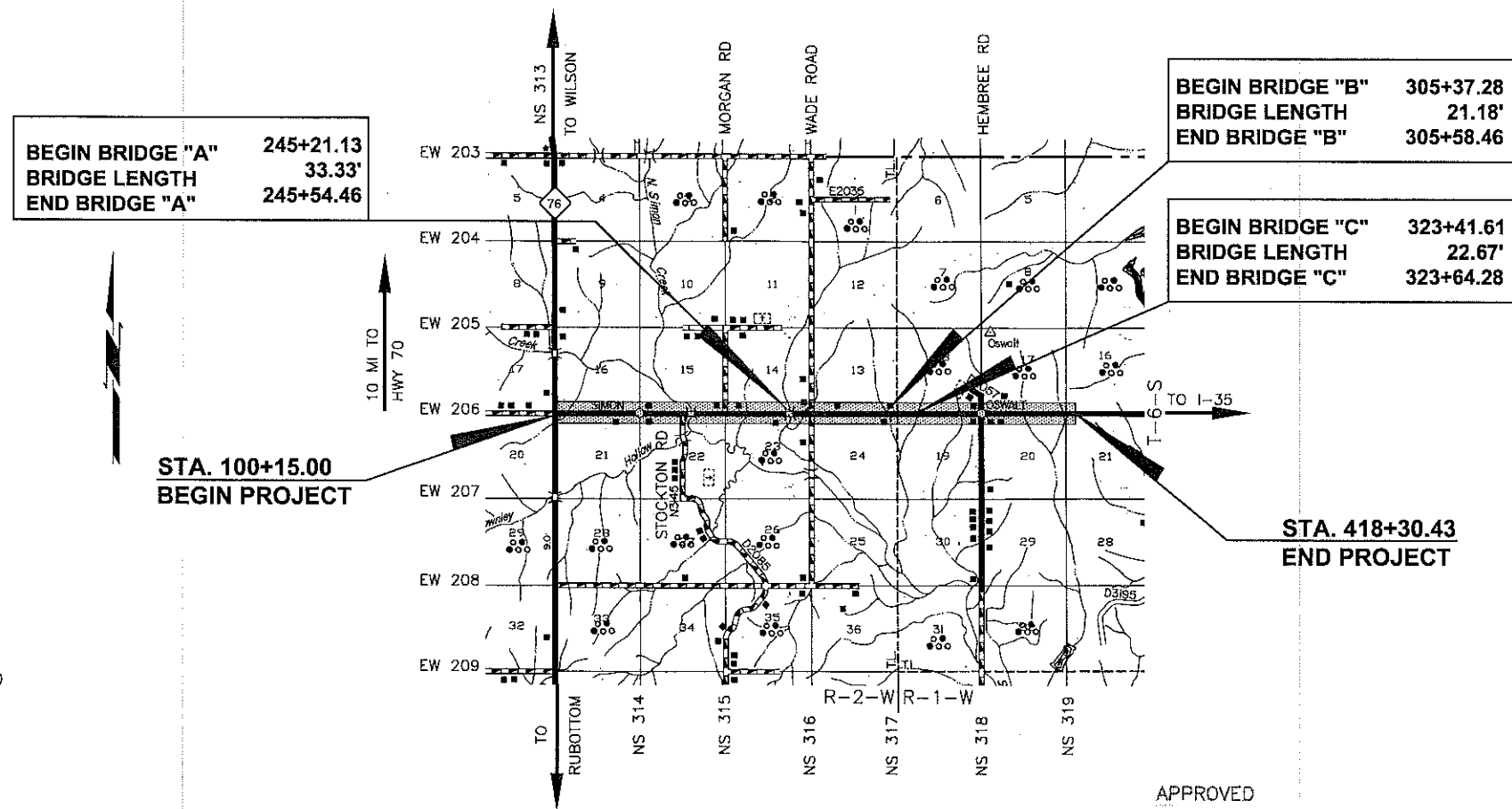

BEGIN BRIDGE "A" 245+21.13
BRIDGE LENGTH 33.33'
END BRIDGE "A" 245+54.46

BEGIN BRIDGE "B" 305+37.28
BRIDGE LENGTH 21.18'
END BRIDGE "B" 305+58.46

BEGIN BRIDGE "C" 323+41.61
BRIDGE LENGTH 22.67'
END BRIDGE "C" 323+64.28

STA. 100+15.00
BEGIN PROJECT

STA. 418+30.43
END PROJECT

PROJECT LENGTH BASED ON C.R.L.
ROADWAY LENGTH: 31,717.61 FT. 6.007 MILES
BRIDGE "A" LENGTH: 33.33 FT.006 MILES
BRIDGE "B" LENGTH: 21.18 FT.004 MILES
BRIDGE "C" LENGTH: 22.67 FT.004 MILES
PROJECT LENGTH: 6.025 MILES
EQUATIONS: NONE
EXCEPTIONS: STA. 183+67.39 - 184+65.21 = 97.82 FT.

APPROVED
LOVE COUNTY BOARD OF COMMISSIONERS

DISTRICT NO. 1
[Signature]
DATE: 3-13-17

DISTRICT NO. 2
[Signature]
DATE: 3-13-17

DISTRICT NO. 3
[Signature]
DATE: 3-13-17

PREPARED BY:
CEC CORPORATION
CA32 PE/LS 6/30/2018
OKLAHOMA CITY, OKLAHOMA

Erica R. Nottnagel
ERICA R. NOTTNAGEL
OKLA. REG. NO. 28049
DATE: 3/14/17

PREPARED BY:
CEC CORPORATION
CA32 PE/LS 6/30/2018
OKLAHOMA CITY, OKLAHOMA

Benjamin J. Knipstein
BENJAMIN J. KNIPSTEIN
OKLA. REG. NO. 28081
DATE: 3-14-17

BRIDGE "C"
AB01, B003, B015-B021

OKLAHOMA DEPARTMENT OF TRANSPORTATION
DATE APPROVED: _____
BY: _____
CHIEF ENGINEER

DEPARTMENT OF TRANSPORTATION
FEDERAL HIGHWAY ADMINISTRATION
DATE APPROVED: _____
BY: _____
DIVISION ADMINISTRATOR

S.A. PROJECT NO. CIRB-143C(091)RB
SHEET NO. 001

LINDA HYMAN, COMMISSIONER, LOVE COUNTY DISTRICT NO. 2
SHELLY MOODY, LOCAL GOVERNMENT DIVISION, OKLAHOMA DEPARTMENT OF TRANSPORTATION
P.E. NO. 25447(01)

2009 OKLAHOMA STANDARD SPECIFICATIONS FOR HIGHWAY CONSTRUCTION-ENGLISH GOVERN.
APPROVED BY THE U.S. DEPARTMENT OF TRANSPORTATION, FEDERAL HIGHWAY ADMINISTRATION, SEPTEMBER 21, 2009.